



Nature-based Park at NW Heckman Ln

CPO 7 Meeting

April 8, 2024

This project received support from Metro thanks to voters investing in nature.

THPRD Community Visioning | 2018 - 2020



13

Visioning Task Force Members

- ✓ Multicultural
- ✓ Multilingual
- ✓ Multigenerational
- ✓ Geographically diverse

Engagement Numbers

10,500

Nearly people reached

12,500+

Ideas collected

117

Engagement opportunities

Long-term
guiding vision

Vision Action
Plan!

Bringing
community
ideas to life

Vision Action Plan Goal Areas



Welcoming and Inclusive

Ideas centered on building community, expanding the role of THPRD in people's lives



Play for Everyone

All the ways people want to play, move, and interact with THPRD



Accessible and Safe

Overall maintenance of facilities and equipment and the ability to access THPRD amenities safely



Preserving Natural Spaces

Ideas that envision opportunities for people to be in and enjoy nature

Read the Vision Action Plan:
www.thprd.org/district-information/visioning/



Vicinity Map

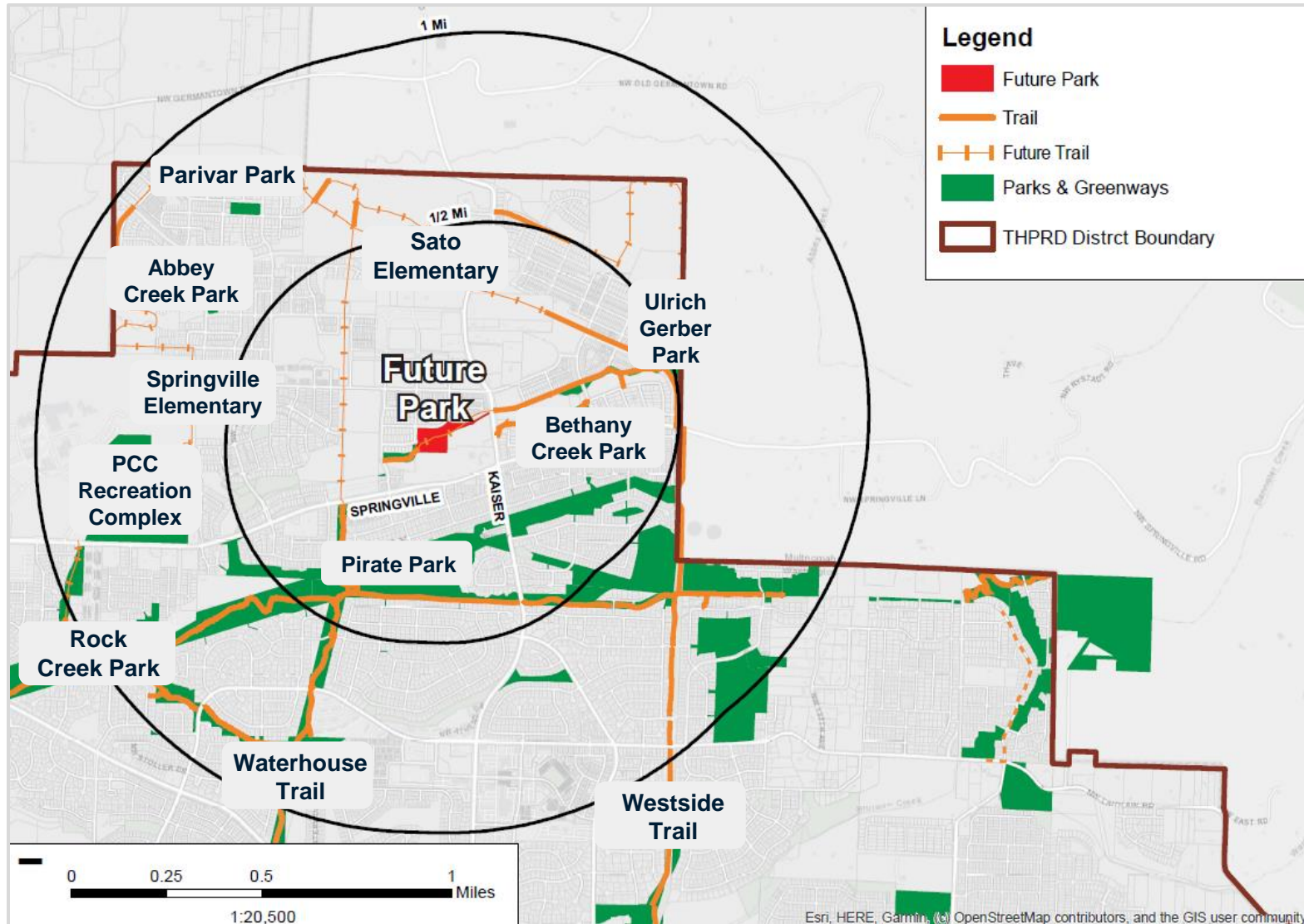

Aerial Map



Aerial Map



Community Engagement



**Nature Family
Fun Night**
June 2023



**Wild Night
Trick or Treat**
October 2023



**Holi
Festival**
March 2024

Community Engagement

- + Community events
- + Online surveys
- + Social media
- + E-newsletters
- + Mailers
- + Webpage

Community Input Summary

What did we hear?

THPRD asked the community what they would like to do in the future nature-based park coming to NW Heckman Ln. This is what we heard.

View & enjoy nature

Native, pollinator, and edible gardens
Natural habitat areas that attract wildlife



Gather & relax in nature

Seating and shelter areas for gathering
Quiet shady areas near trees and water



Learn & explore in nature

Interpretive and multilingual signage
Learn about native plants and animals



Exercise & play in nature

Trails and all age and ability activities
Climbing, scavenger hunts, and tactile play



Park Themes

- Multicultural
- Trees, plants and natural waters
- Birds, pollinators, and native wildlife

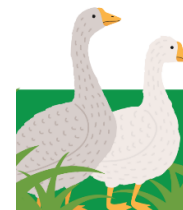

Community Engagement

- + Community events
- + Online surveys
- + Social media
- + E-newsletters
- + Mailers
- + Webpage

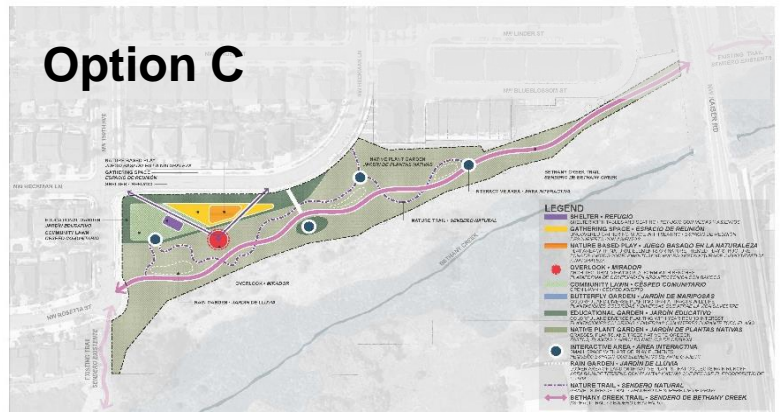
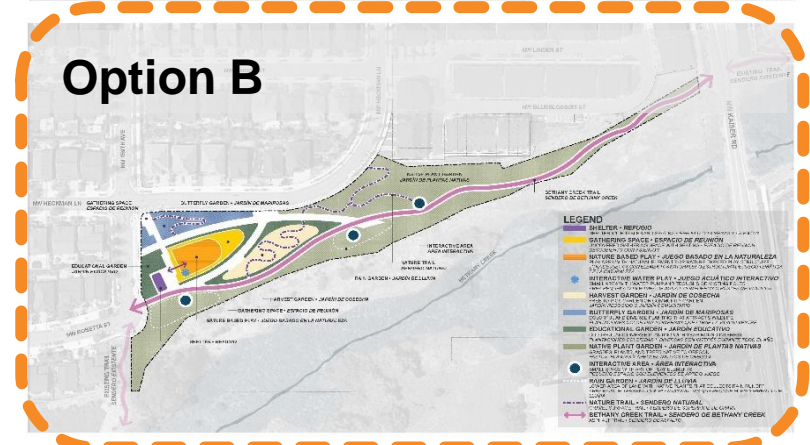
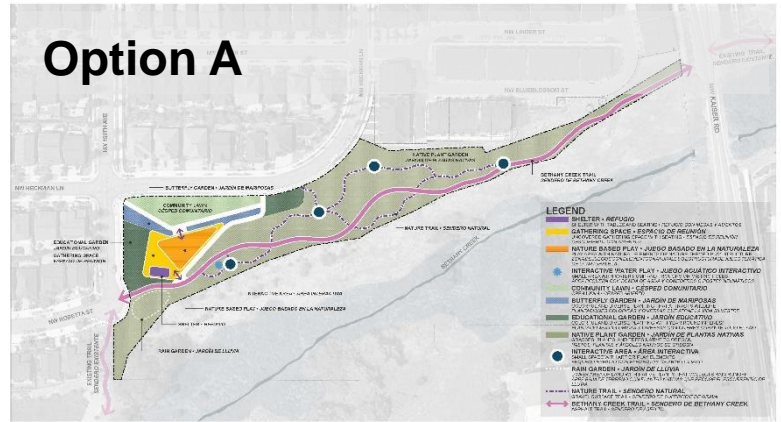

Preferred Concept Plan

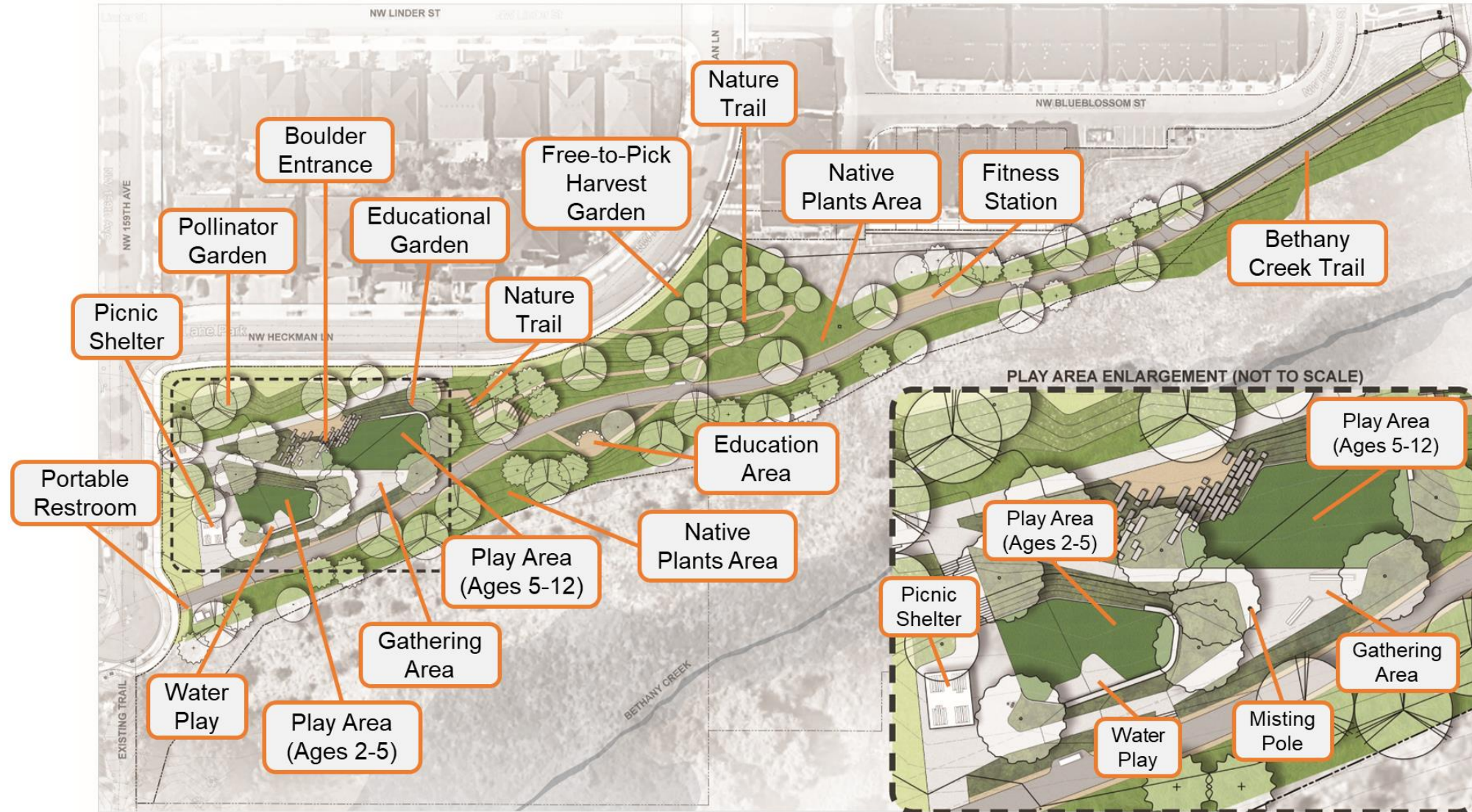

Preliminary Concept Plan



These images are examples to show possible options and do not reflect the exact play features of the future park.



Preliminary Concept Plan



These images are examples to show possible options and do not reflect the exact play features of the future park.

Preliminary Concept Plan

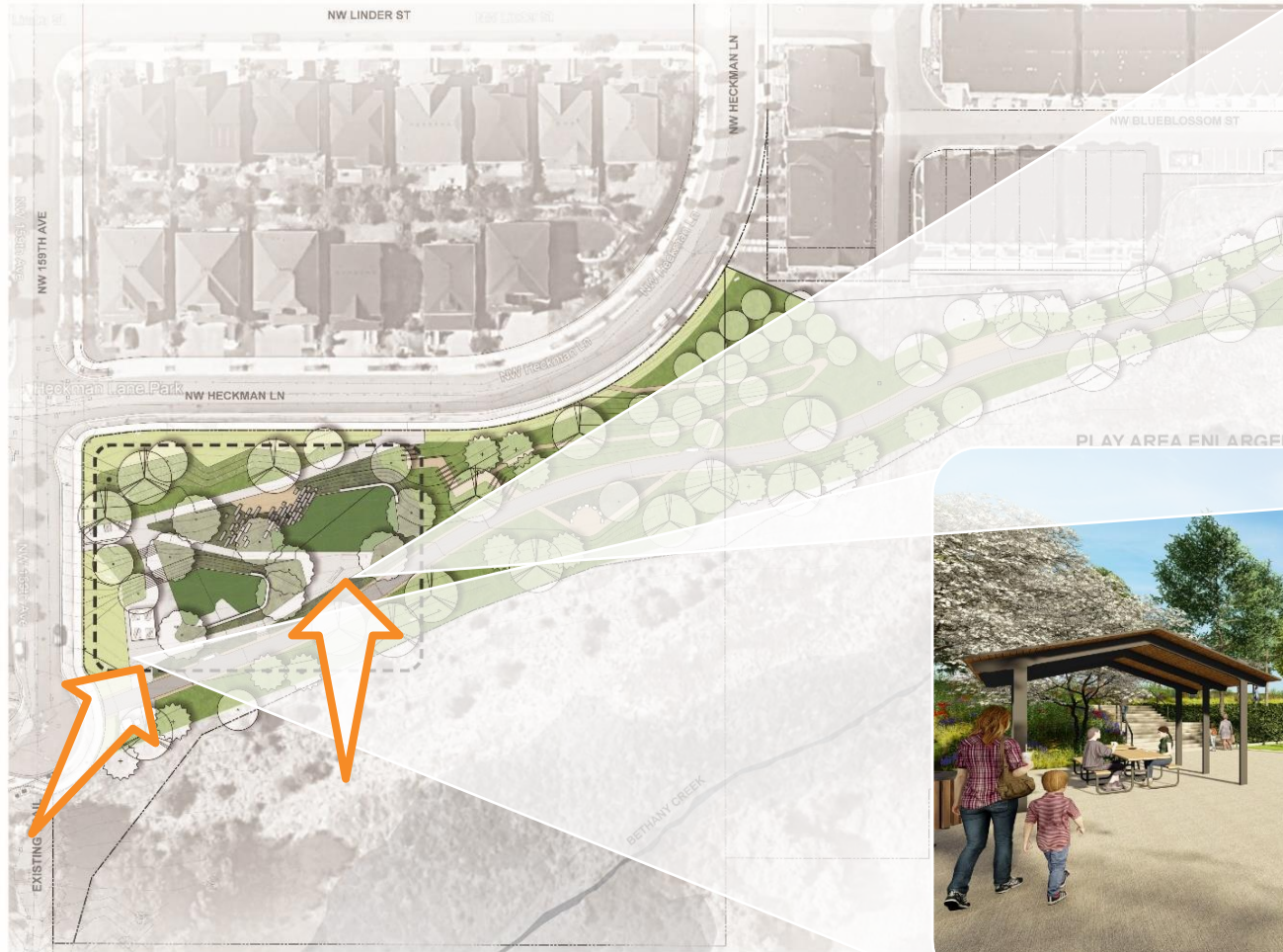

These images are examples to show possible options and do not reflect the exact play features of the future park.



Preliminary Concept Plan

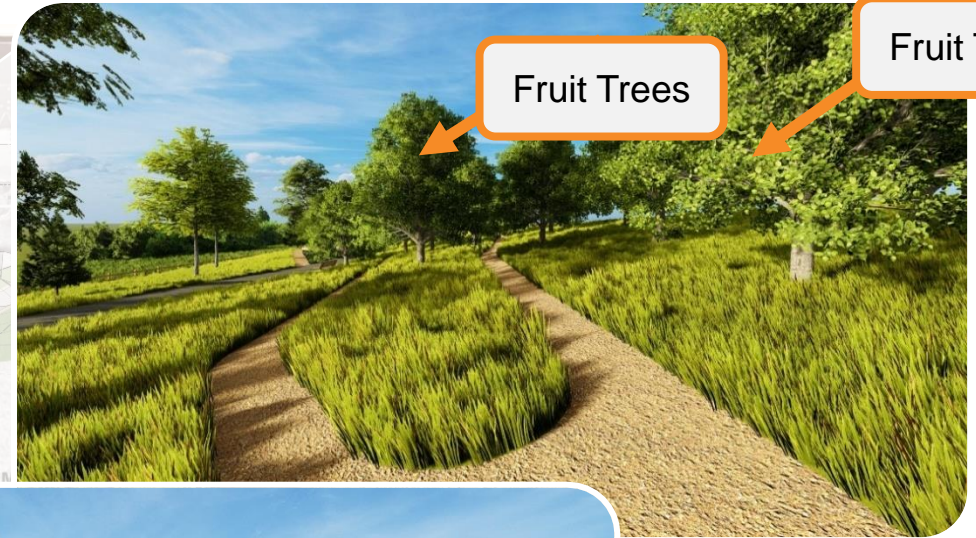

These images are examples to show possible options and do not reflect the exact play features of the future park.



Play Area Survey: Ages 2-5



These images are examples to show possible options and do not reflect the exact play features of the future park.

Play Area Survey: Ages 5-12



These images are examples to show possible options and do not reflect the exact play features of the future park.

How do we name parks?



- + **Park names** that to match the diversity of the community
- + **Intentionally inclusive outreach** with cultural partners
- + **Engagement** through in-depth discussions, historic and photographic archives
- + **Honor and reflect** the diverse experiences, identities, and ecologies across the district

Park Name

Saqasqa Park *(sahk/a/sahk/a)*

- + Arabic onomatopoeia for a bird's **tweet-tweet** sound
- + Brings life to the **community's vision** of a place to observe birds and other wildlife
- + Prompts visitors to listen for the **frequent singing of birds** in the nearby wetlands
- + **Signs** in the park can help explain the meaning of the name



Timeline

Spring 2023 – Spring 2024

- Finalize community engagement
- Concept plan approval

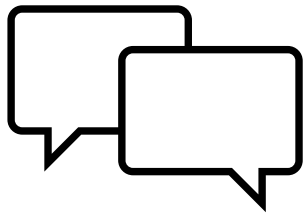

Summer 2024 – Fall 2025

- Agency reviews
- Construction documents
- Permitting process

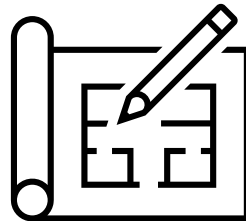

Winter 2026 – Fall 2026

- Bid for construction contractors
- Site preparation
- Construction

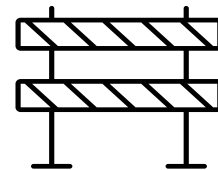

Preferred Concept Plan



This project received support from Metro thanks to voters investing in nature.

Waterhouse Trail

- Merlo Station to PCC Rock Creek
- Connects to 3 regional and 3 community trails
- Includes play equipment, multi-use field, basketball courts, and community gardens
- Challenges: Pedestrian barriers

Spring 2024

Execute IGA

Spring 2024

Land use applications and development permits

**Summer–
Fall 2024**

Construction

Learn more at:

www.washingtoncountyor.gov/lut/projects/waterhouse-trail-crossings

www.washingtoncountyor.gov/lut/projects/laidlaw-road-and-waterhouse-trail



Westside Trail

- Feasibility studies help raise funds
- Pedestrian bridge crossing over Hwy 26:
 - ✓ Total cost estimate between \$14 to \$27.2 million
 - ✓ Continually working toward development
 - ✓ Continually securing additional grant funds

Fall 2021

Completed feasibility study for pedestrian bridge

Fall 2022

\$1.9 million Metro grant for design and permits

Summer 2024

Feasibility study connecting SW 158th & Walker to Kaiser

Summer 2026

Expect construction on trails connecting to the bridge

Learn more at:

www.thprd.org/parks-in-progress/westside-trail-bridge/



What's next?



Still have questions or comments?

Email: N.Paulsen@thprd.org

Call: 503-629-6305

Project webpage: thprd.info/nw159thheckman



Take the play area survey!

Scan this code to get started:



Learn about THPRD's Local Levy Option

Coming in May 2024!

Visit us online: www.thprd.org

