

SW 198TH AVENUE IMPROVEMENTS: SW FARMINGTON RD TO SW T.V. HWY

SW BLANTON STREET REALIGNMENT ALTERNATIVE 1 - WEST LEG REALIGNMENT



WASHINGTON COUNTY

JUNE 2, 2016

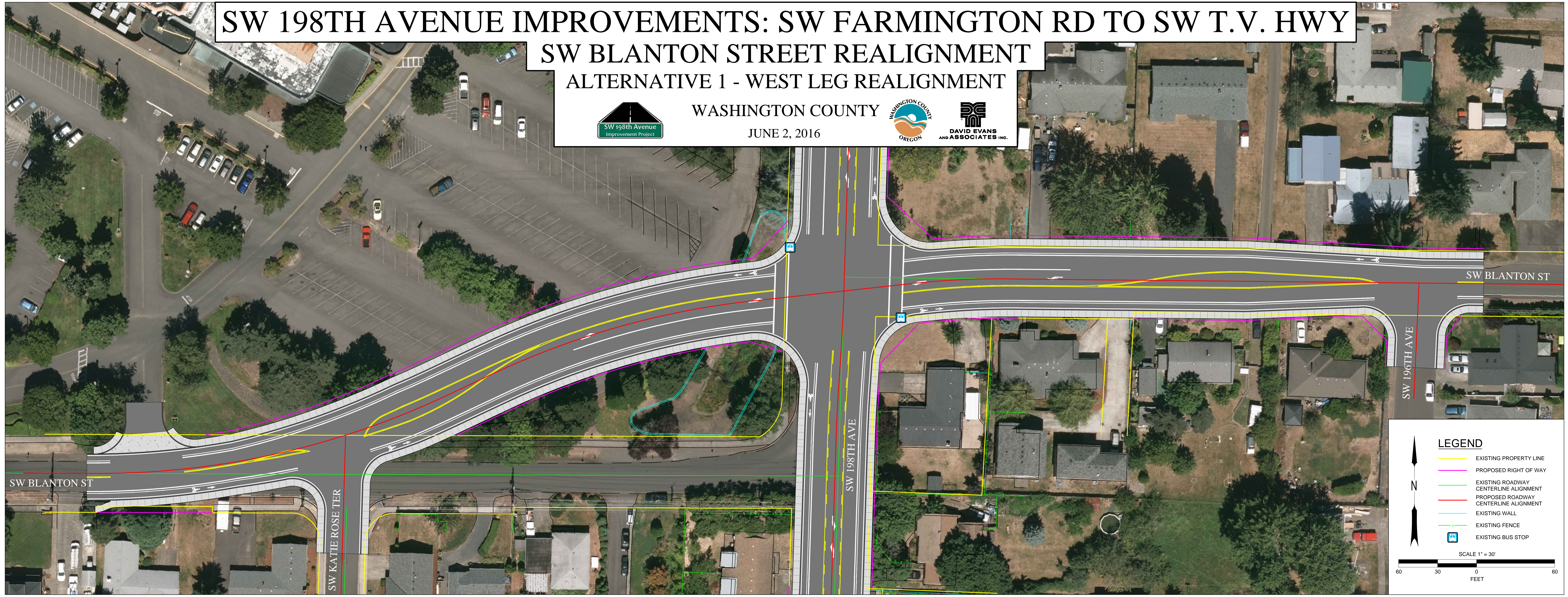

LEGEND

- EXISTING PROPERTY LINE
- PROPOSED RIGHT OF WAY
- EXISTING ROADWAY CENTERLINE ALIGNMENT
- PROPOSED ROADWAY CENTERLINE ALIGNMENT
- EXISTING WALL
- EXISTING FENCE
- EXISTING BUS STOP

SCALE 1" = 30'

60 30 0 60
FEET