

1.

# FIELD VERIFICATION OF SIGNAL POLE FOUNDATION

PROJECT NAME: \_\_\_\_\_ CONTRACT NO.: \_\_\_\_\_ POLE NO.: \_\_\_\_\_

POLE TYPE: \_\_\_\_\_ MAJOR ROAD: \_\_\_\_\_ CROSS ROAD: \_\_\_\_\_ PREPARER: \_\_\_\_\_ DATE: \_\_\_\_\_

**Bold values initially provided by Design team.**

13. Top of Anchor Rods  
Elev: \_\_\_\_\_ (feet)  
(No.7 + (No.16/(12"/ft))

15. Anchor Rod Diameter  
("AD"): \_\_\_\_\_ (inches)  
Rod Circle Dia: \_\_\_\_\_ (inches)

16. Anchor Rod Projection from Foundation Control Point: \_\_\_\_\_ (inches)  
(1" + "BT" + 1/8" + "AD" + 1")

7. Back of Walk/Curb (Foundation Control Point)  
Elev: \_\_\_\_\_ (feet)

**\* Report all feet to the hundredths and inches to the thousandths decimal place.**

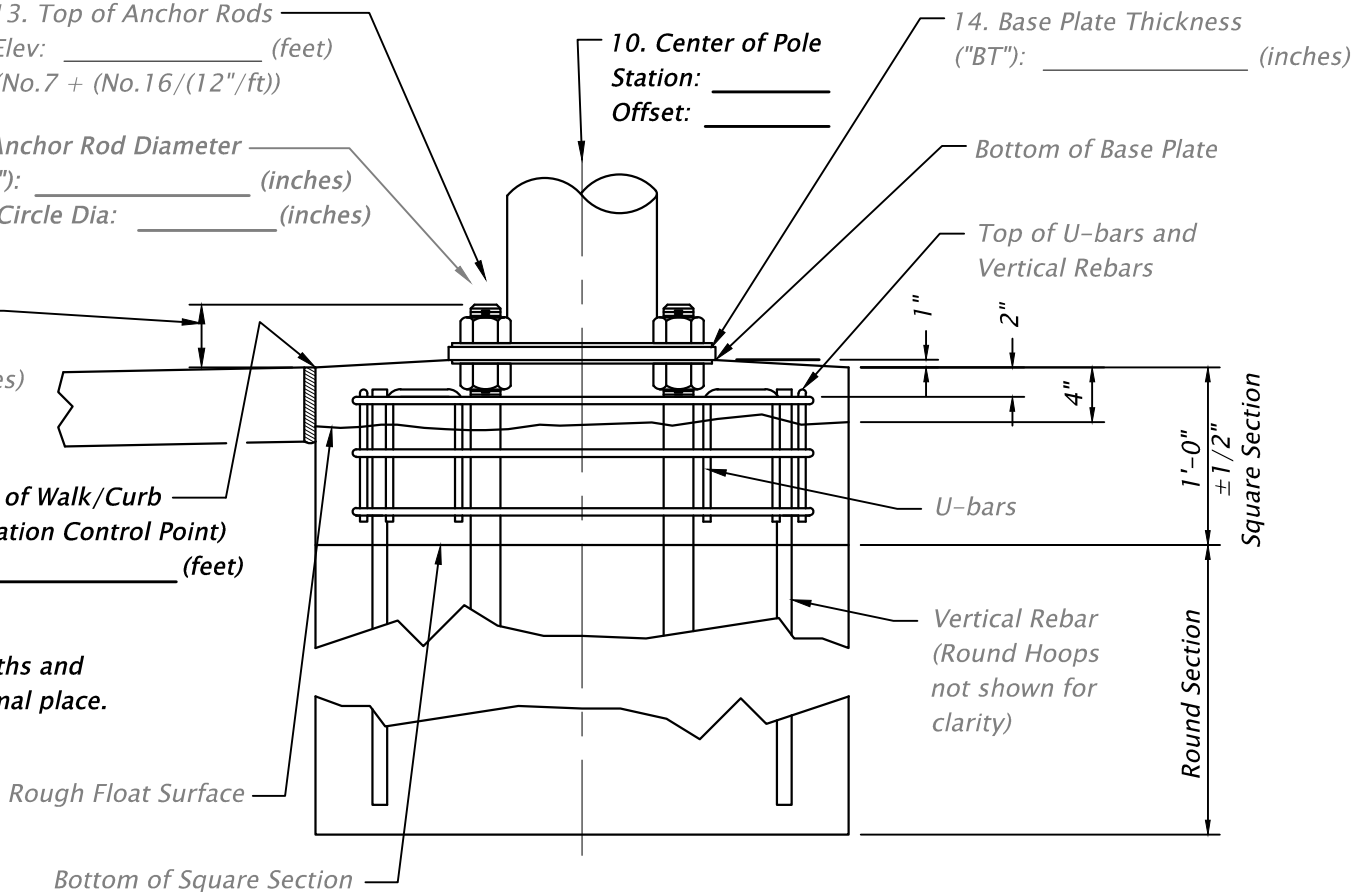

17. Reviewed By: \_\_\_\_\_ Date: \_\_\_\_\_

18. Not Used: \_\_\_\_\_

**Notes:**

1. OFFSET DIMENSIONS SHALL BE MEASURED FROM THE ROADWAY CENTERLINE.
2. SEE WASHINGTON COUNTY STANDARD DETAILS 6911, 6912, 6913 AND 6921, 6922 FOR SIGNAL SUPPORT AND FOOTING DETAILS.
3. NOTE RELATION TO UTILITY FEATURES, UTILITY LOCATES, & ANY ROADWAY FEATURES (SURFACE & OVERHEAD). INCLUDE ADDITIONAL SKETCH MAPS IF NECESSARY.
4. SHOW FINAL CROSS SECTION. INCLUDE ALL OVERLAYS AND EARTHWORK.

FIELD VERIFICATION OF SIGNAL POLE FOUNDATION

WASHINGTON COUNTY  
DEPARTMENT OF LAND USE &  
TRANSPORTATION  
ENGINEERING SECTION



6920

WASH. CO. #

EFFECTIVE DATE: 01/01/2022

PLOT STAMP: 12/02/21 2:21P RJXM  
CAD: S\_FV-P-F.DWG